



**15 Cornelia Crescent, Belvidere, Shrewsbury, SY2 5NA**

3 bedroom semi-detached house — £325,000 Freehold

# 15 Cornelia Crescent, Belvidere, Shrewsbury, SY2 5NA

Coopergreenpooks.co.uk

£325,000 Freehold — 3 bedroom semi-detached house

sales@cgpooks.co.uk

Occupying a lovely quiet position, with a south facing garden, this neatly presented semi-detached property has been extended and improved to provide spacious and versatile accommodation throughout.

## KEY FEATURES

- Good sized living room with feature open fireplace and glazed doors onto the garden
- Modern fitted kitchen/dining room, complete with integrated appliances and windows to two elevations
- Lovely conservatory with a solid roof, central heating and glazed double doors to the rear
- Two double bedrooms and a family bathroom on the ground floor
- A well-designed loft conversion provides an impressive master bedroom with exposed timbers, plenty of storage and velux windows to the front and rear
- uPVC double glazed windows and gas fired central heating
- Beautifully landscaped south facing garden, laid to lawn with paved terraces, planted borders and timber log/bin store. There are further lawned and planted gardens to the front of the property, extending to the side
- Private driveway providing parking for two cars and access to the detached single garage
- A very quiet and convenient location, just a short distance from a range of excellent local amenities, primary and secondary schools, as well as being less than two miles from the town centre

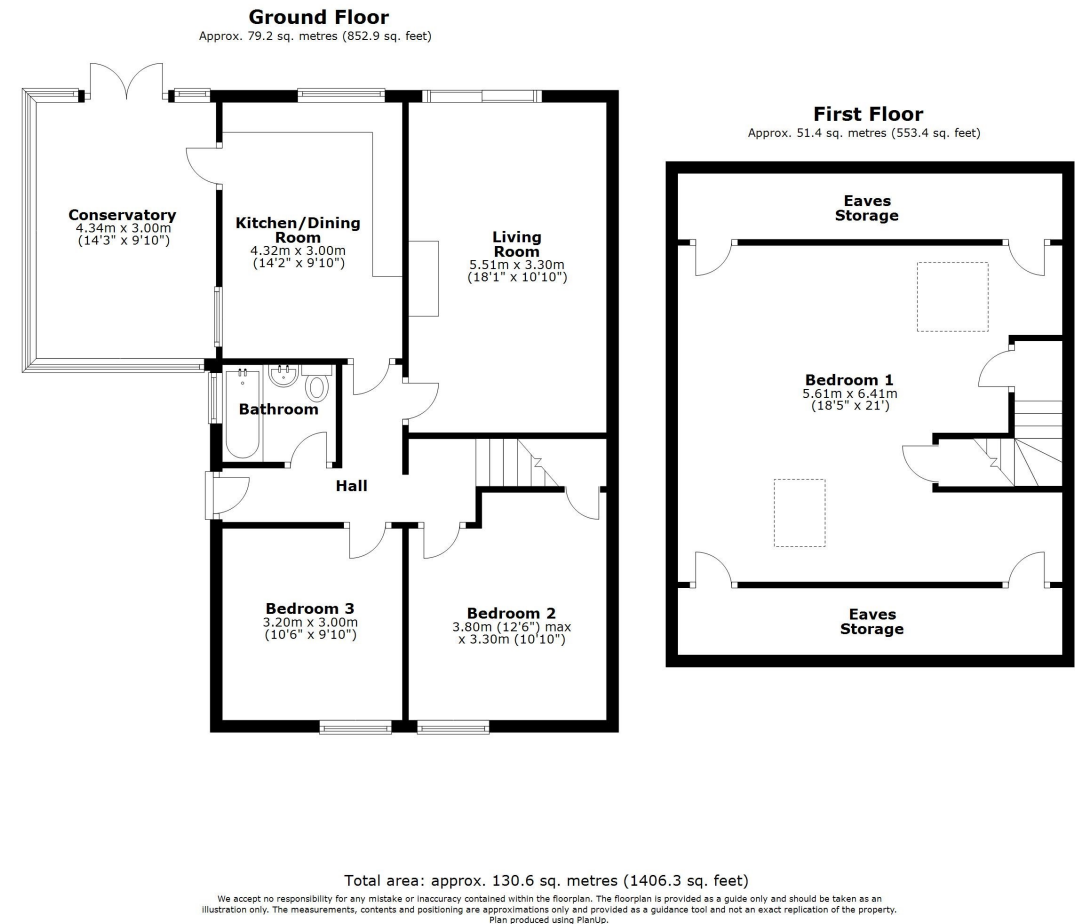







## 15 Cornelia Crescent, Belvidere, Shrewsbury, SY2 5NA

£325,000 Freehold — 3 bedroom semi-detached house

[sales@cgpooks.co.uk](mailto:sales@cgpooks.co.uk)



BOUNDARIES NOT CONFIRMED

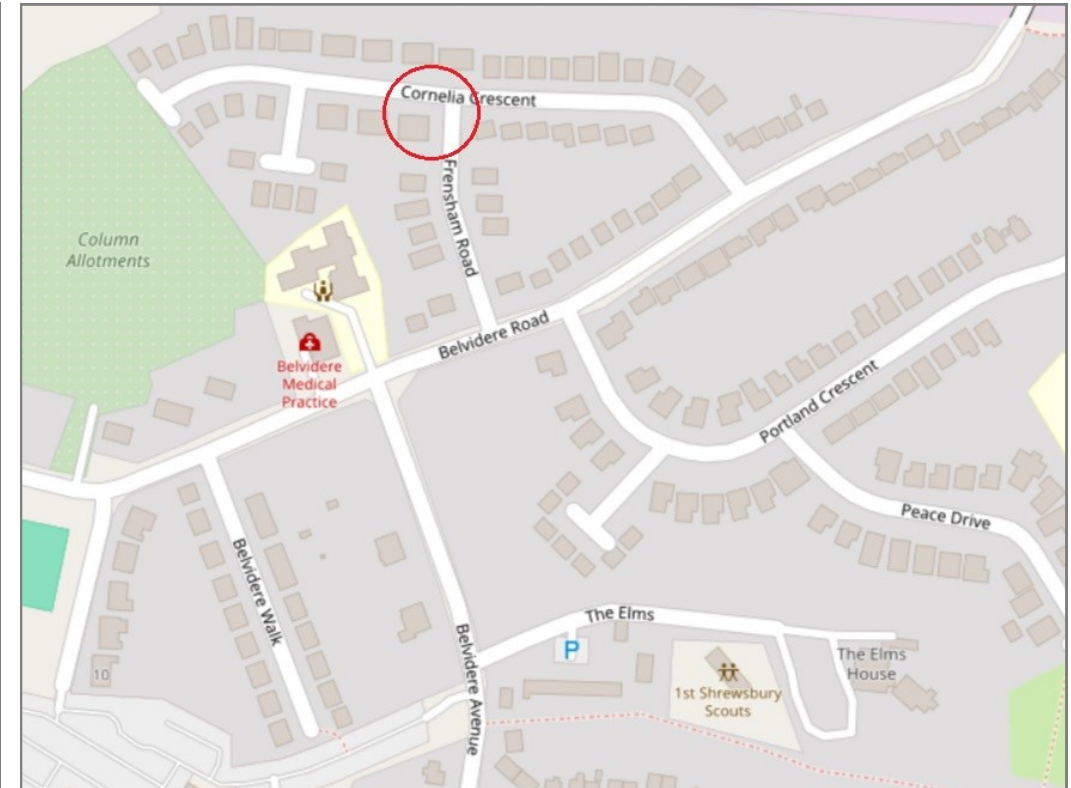

Tenure	Freehold
Local Authority	Shropshire Council
Council Tax	Band B
EPC Band	Band D
Services	All mains services are connected

**Expert mortgage advice available**  
3 Barker St, Shrewsbury SY1 1QF  
**Cooper Green Pooks**  
**01743 276666**



Your home may be repossessed if you do not keep up repayments on your mortgage.  
There may be a fee for mortgage advice. The actual amount you pay will depend upon your circumstances. The fee is up to 1% but a typical fee is 0.3% of the amount borrowed.

## 15 Cornelia Crescent, Belvidere, Shrewsbury, SY2 5NA

Coopergreenpooks.co.uk

£325,000 Freehold — 3 bedroom semi-detached house

sales@cgpooks.co.uk



**IMPORTANT NOTICE:** Cooper Green Pooks for themselves and for the lessors or vendors of this property whose agents they are give notice that: 1 No appliances, services or service installations have been tested and no warranty as to suitability or serviceability is implied. Any prospective purchaser or lessee is advised to obtain verification from their surveyor or solicitor. 2. The particulars are set out as a general outline only for the guidance of the intended purchasers or lessees and do not constitute, nor constitute part of, an offer or contract. 3. All descriptions, reference to condition and necessary permissions for use and occupation and other details are given in good faith and are believed to be correct but any intending purchasers or lessees should not rely on them as statements or representation of fact but satisfy themselves by inspection or otherwise as to the correctness of each of them. 4. No person in the employment of Cooper Green Pooks has any authority to make or give any representation or warranty whatsoever in relation to this property. 5. All rentals and prices are quoted exclusive of Stamp Duty, legal and surveyors fees and any other associated purchasers or lessees costs. 6. Floor plans are indicative only and should not be relied on. 7. The plan showing the boundary of the property is indicative only and has not been checked against the legal title so should not be relied on. 8. All dimensions, floor areas and site areas are only approximate and should not be relied on. Dimensions are generally maximum room dimension.